



Quick Start Guide: AMG & EMG



AMG
Acceleromyography

EMG
Electromyography

- CS Průvodce rychlým spuštěním
- DA Guide til hurtig start
- DE Schnellstartgeber
- EL Οδηγός Γρήγορης Εκκίνησης
- ES Guía de inicio rápido

- FR Guide de démarrage rapide
- IT Guida rapida all'uso
- JA クイックスタートガイド
- KO 빠른 시작 가이드
- LV Pamata Lietošanas instrukcija

- NL Snelstartgids
- NO Hurtigstart-guide
- PL Podręcznik szybkiej instalacji
- PT Ghid Start rapid
- RU Guía de inicio rápido

XM400-21QSGP04-02
November 2023



Xavant Technology (Pty) Ltd

Unit 102, The Tannery Industrial Park,
309 Derdepoort Rd,
Silverton, Pretoria, South Africa, 0184
Tel: +27 (0) 12 743 5959
E-mail: support@xavant.com
Web: www.xavant.com



Emergo Europe

Westervoortsedijk 60,
6827 AT Arnhem
The Netherlands



MedEnvoy Switzerland

Gotthardstrasse
6302 Zug
Switzerland



Europe MedEnvoy

Prinses Margrietplantsoen 33
Suite 123
2595 The Hague, The Netherlands



Switzerland
Anandic Medical Systems AG
Stadtweg 24,
CH-8245, Feuerthalen - Schweiz

Sponsors

Australia
Teleflex Medical Australia
Level 4, 197 Coward St
Mascot NSW 2020

Caution

Federal (US) law restricts this device to
sale by or on the order of a physician.

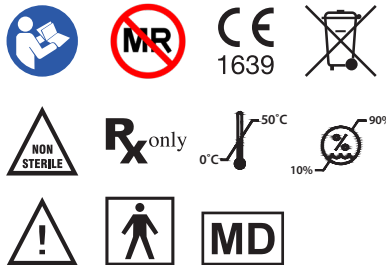

university.xavant.com



youtube.com/c/XavantTechnology



xavant.com/docs



English	4
Czech (Čech)	7
Danish (Dansk)	10
Dutch (Nederlands)	13
French (Français)	16
German (Deutsche)	19
Greek (Ελληνικά)	22
Italian (Italiano)	25
Japanese (日本語)	28
Korean (한국어)	31
Latvian (Latviski)	34
Norwegian (Norsk)	37
Polish (Polskie)	40
Portuguese (O Português)	43
Romanian (Româna)	46
Spanish (El Español)	49





Quick Start

English

I NMT Monitoring: AMG Setup



1 Check Batteries & Switch Device On

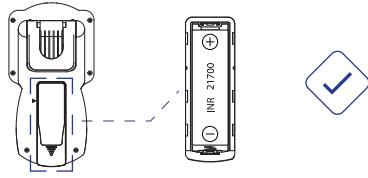

Power on device

2 Connect NMT Monitoring Cable AMG

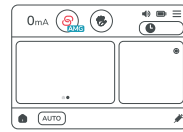
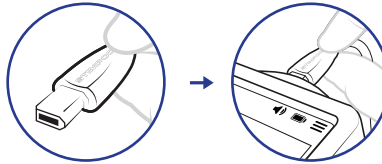

3 Prepare Patient's Skin for Monitoring

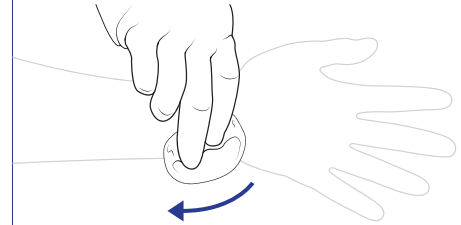

4 Attach Electrodes

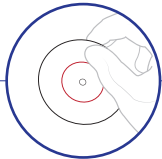

5 Connect Clips to the Electrodes

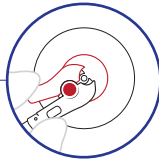

6 Attach Accelerometer to Appropriate Contracting Appendage

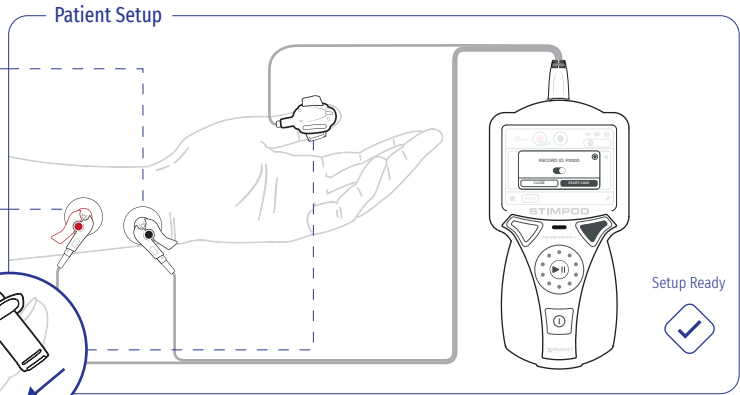



Quick Start

English

NMT Monitoring: EMG Setup



1 Check Batteries & Switch Device On

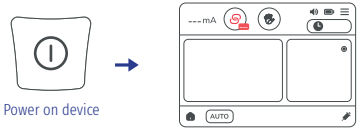
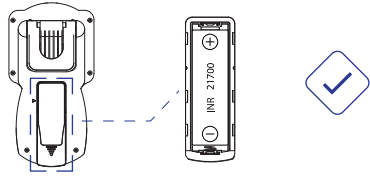

2 Connect NMT Monitoring Cable EMG

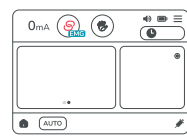
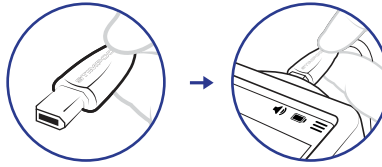

3 Prepare Patient's Skin for Monitoring

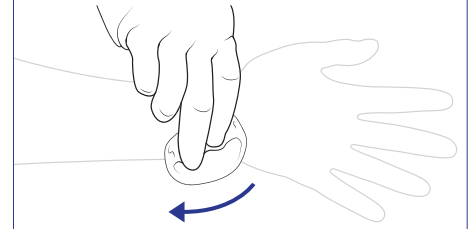

4 Attach EMG Electrode to Patient

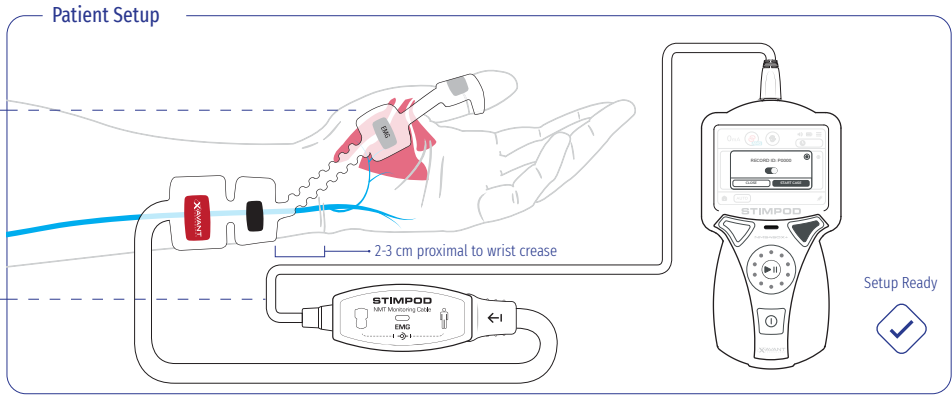

5 Connect EMG Electrode to the NMT Monitoring Cable EMG

You Choose: **Patient Stimulation Options**

Option A: OneTouch NMT (AUTO Mode)

- 1 **Start Case**
 Toggle case recording **On/Off**. Select **START CASE** to initiate **Auto** mode.
- 2 **Full Case Monitoring Initiated**
Reference current and **Depth of Block** automatically determined and monitored.
- 3 **Select Desired View**
Swipe to navigate through the available waveforms/views

Option B: Manual Stimulation

- 1 **Press the Mode button to select mode**
- 2 **Select Stimulation Mode**
 Select **TOF** mode. Confirm mode selection.
- 3 **Adjust current as required**
 Adjust using **scroll wheel** + **Press Enter**
 Or
 Adjust using **touch display**
- 4 **Press Play to Initiate Stimulation**
 Press **Play** key
 Short Press for **Single Stimulation**
 Or
 Long Press (>2sec) for **Repeat Stimulation**

Cleaning and Disinfecting

- ▶ **Cleaning:** Soap and water, applied with a damp cloth is suitable to clean and disinfect the STIMPOD. It is imperative that no moisture penetrates the STIMPOD.
- ▶ **Disinfecting:** Any commercially available methanol-free disinfectant in an ethyl alcohol base can be used for disinfection.



Rychlé spuštění

Czech (Čech)

NMT Monitoring: Nastavení AMG



- 1 Zkontrolujte baterie a zapněte zařízení

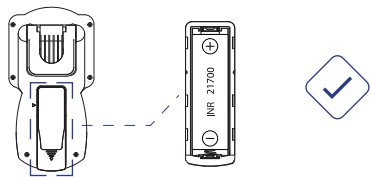

- 2 Připojte NMT monitorovací kabel AMG

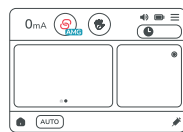
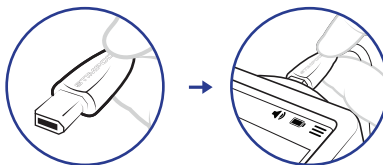

- 3 Připravte pacientovu kůži pro sledování

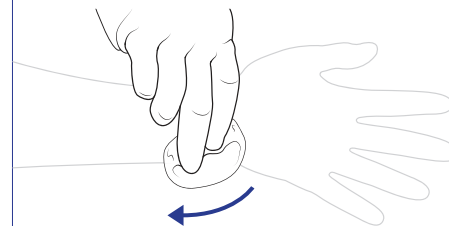

- 4 Připojte elektrody

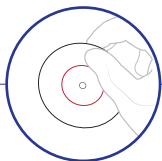

- 5 K elektrodám připojte svorky

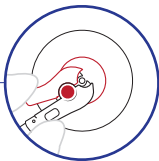

- 6 Připojte akcelerometr k příslušné stahované končetině nebo jiné části těla



Nastavení pacienta

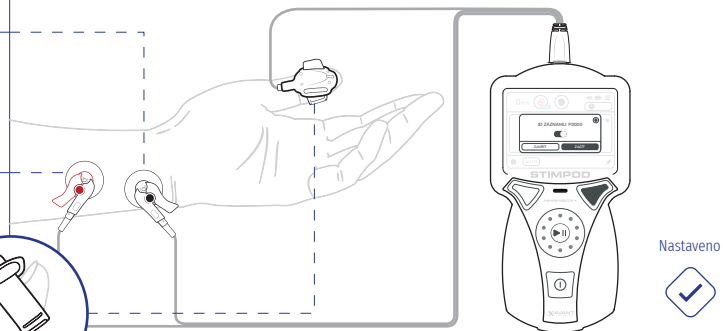



Rychlé spuštění

Czech (Čech)

NMT Monitoring: Nastavení EMG



1 Zkontrolujte baterie a zapněte zařízení

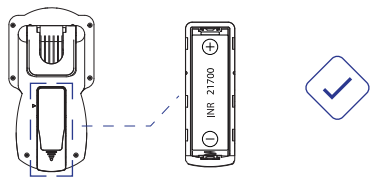

2 Připojte NMT monitorovací kabel EMG

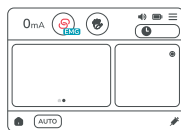
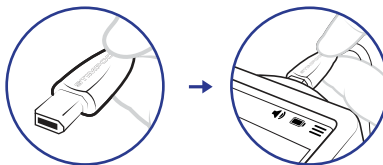

3 Připravte pacientovu kůži pro sledování

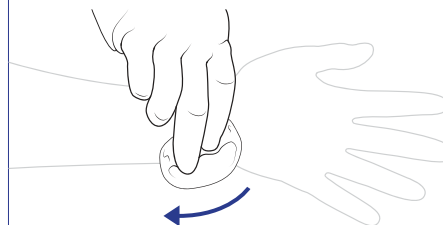

4 Připojte EMG el elektrody k pacientovi

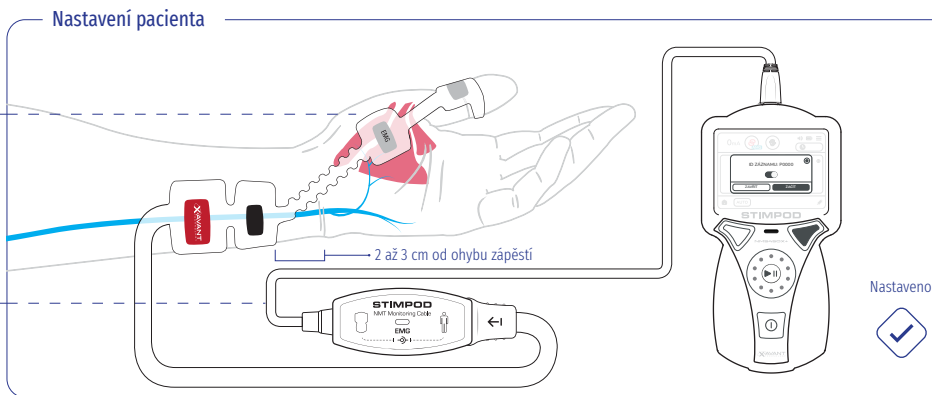

5 Připojte EMG el elektrody k NMT Monitorovacímu kabelu EMG

Vyberte si: **Možnosti stimulace pacientů**

I Volba A: **OneTouch NMT (Automatický režim)**

- 1** Zahájit nové měření

Zapnout/vypnout nahrávací stav Zvolte **ZAHÁJIT NOVÉ MĚŘENÍ** pro spuštění automatického režimu



Nebo
- 2** Spuštění sledování celého pouzdra

Referenční proud a hloubka bloku se automaticky určují a monitorují



- 3** Vybrat požadovaný pohled

Přejítím prstem procházíte dostupnými průběhy/pohledy

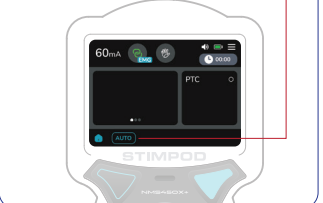

I Volba B: **Manuální stimulace**

- 1** Stisknutím tlačítka Režim vyberte režim

- 2** Vyberte režim stimulace

Zvolte režim TOF Potvrďte výběr režimu

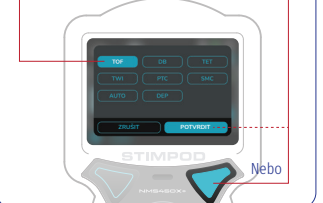

Nebo
- 3** Upravte proud dle požadavků

Úprava pomocí **rotovacího kolečka**

Stiskněte **Enter**



Nebo

Úprava pomocí **dotykového displeje**
- 4** Stiskněte Play pro spuštění stimulace

Stiskněte tlačítko **Play**

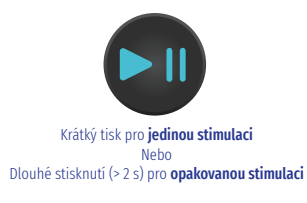

Krátký tisk pro **jedinou stimulaci**

Nebo

Dlouhý stisknutí (> 2 s) pro **opakovanou stimulaci**

I **Čištění a Dezinfekce**

- ▶ **Čištění:** Mýdlová voda aplikovaná měkkou tkaninou. Je nutné dbát, aby se do STIMPODu nedostala žádná vlhkost.
- ▶ **Dezinfekce:** Jakýkoliv komerčně dostupný dezinfekční prostředek bez methanolu a ethylalkoholového základu.



Hurtig Start

Danish (Dansk)

NMT-overvågning: Opsætning af AMG



1 Tjek batterier og tænd for enhed

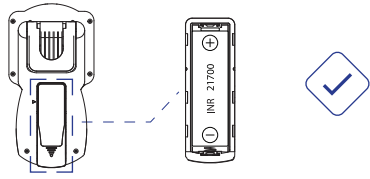

Tænd for enhed

2 Tilslut NMT-overvågningskabel-AMG

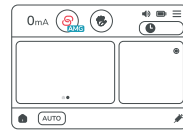
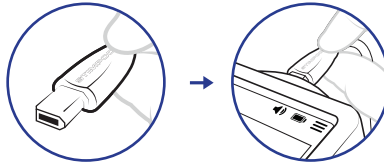

3 Forbered patientens hud til overvågning

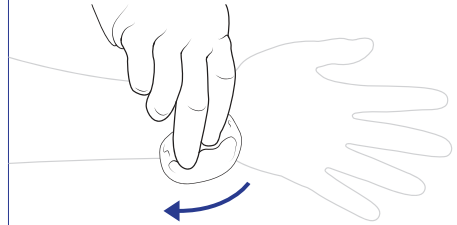

4 Fastgør elektroder

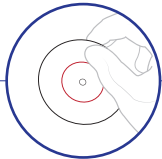

5 Tilslut klemmer til elektroderne

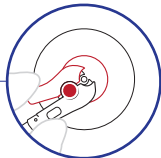

6 Fastgør accelerometer til en passende sammentrækkende muskel

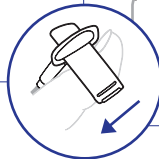

Opsætning af Patient

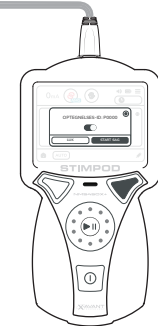
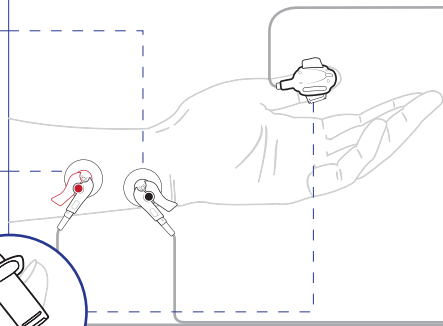

Opsætning klar





Hurtig Start

Danish (Dansk)

NMT-overvågning: Opsætning af EMG



1 Tjek batterier og tænd for enhed

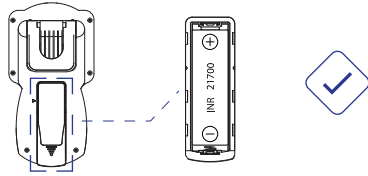

2 Tilslut NMT-overvågningskabel-EMG

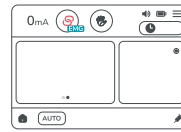
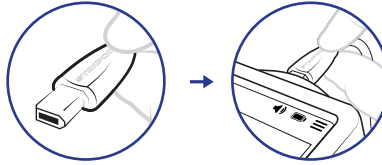

3 Forbered patientens hud til overvågning

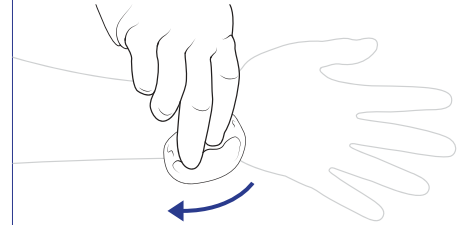

4 Fastgør EMG-elektrode til patienten

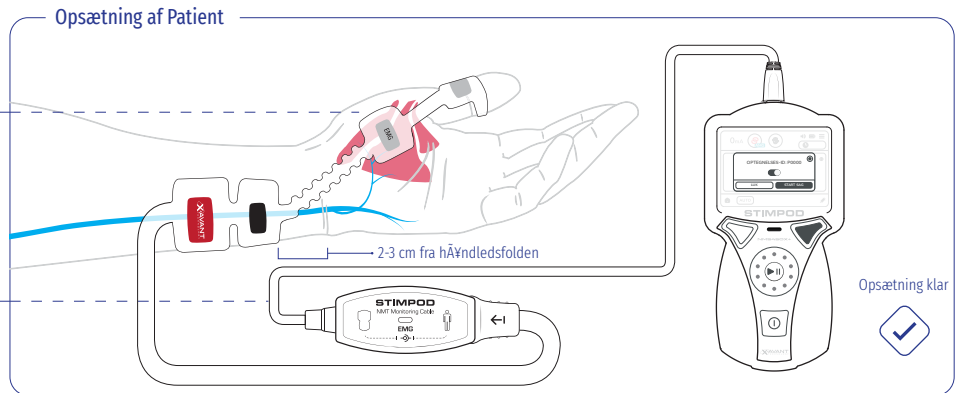

5 Tilslut EMG-elektrode til NMT-overvågningskabel-EMG

Dit valg: **Patientstimuleringsmuligheder**

H Mulighed A: OneTouch-NMT (AUTO-tilstand)

- 1 Start nyt tilfælde**

Slå optagelse til/fra Vælg **START NYT TILFÆLDE** for at starte overvågning i **Auto-tilstand**



Eller
- 2 Fuld overvågning started**

Referencestrøm og **blokdybde** bliver automatisk fastslået og overvåget

- 3 Vælg den ønskede visning**

Stryg for at navigere gennem de tilgængelige bølgeformer/visninger



H Mulighed B: Manuel Stimulering

- 1 Tryk på knappen Tilstand for at vælge tilstand**

- 2 Vælg Stimuleringsstilstand**

Vælg tilstanden **TOF** Bekræft den valgte tilstand



Eller
- 3 Juster strømmen efter behov**

Juster med hjælp af **rullehjulet**

Tryk på **Enter**

Eller Juster med hjælp af berøringsskærmen

- 4 Tryk på play for at starte stimulering**

Tryk på **afspilningstasten**



Kort tryk for **enkel simulering**
Eller
Langt tryk (> 2 sek) for **gentaget simulering**

I Rensning og Desinficerin

- ▶ **Rensning:** Vand og sæbe påført med en fugtig klud passende rengøring og desinficering af instrumentet. Der må under ingen omstændigheder trænge fugt ind i instrumentet.
- ▶ **Desinficering:** Enhver type metanolfri desinfektionsmiddel i en etylalkoholbase, der er tilgængelig i almindelig handel, kan anvendes til desinfektion.



Snelstart

Dutch (Nederlands)

I NMT-Monitoring: AMG Instellen



1 Batterijen controleren en apparaat inschakelen

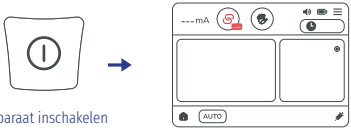
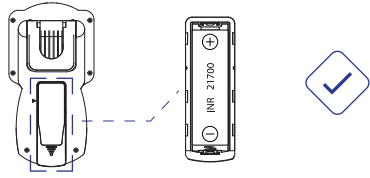

2 Verbind de NMT-Monitoringkabel AMG

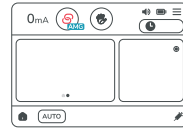
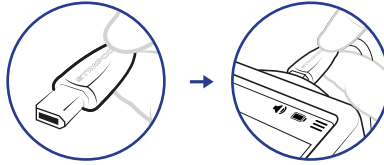

3 Voorbereiding Huid Patiënt voor Monitoring

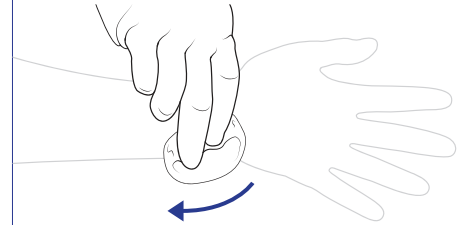

4 Elektrodes verbinden

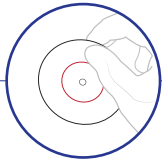

5 Clips verbinden met elektrodes



6 Bevestig de accelerometer aan het juiste samentrekkende lichaamsdeel



Instellingen patiënt

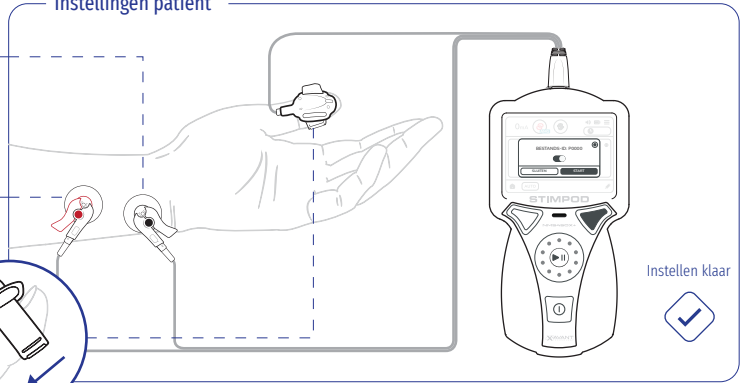



Snelstart

Dutch (Nederlands)

NMT-Monitoring: EMG Instellen



1 Batterijen controleren en apparaat inschakelen

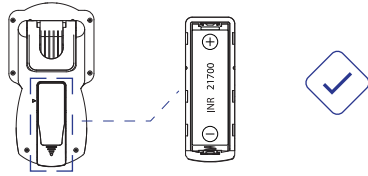

2 Verbind de NMT-Monitoringkabel EMG

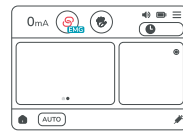
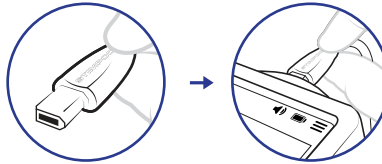

3 Voorbereiding Huid Patiënt voor Monitoring

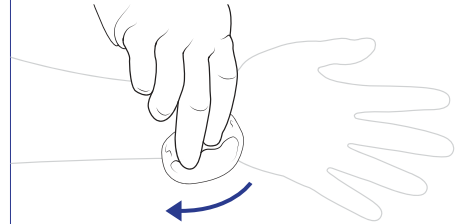

4 Verbind de EMG-Elektrode met de Patiënt

Instellingen Patiënt

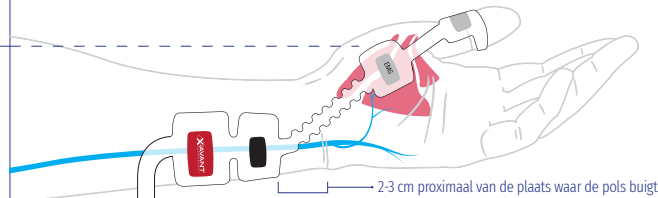

5 Verbind de EMG-Elektrode met de NMT-monitoringkabel EMG

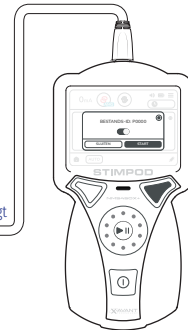
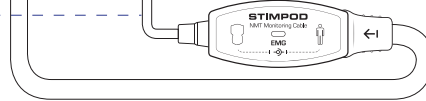

Instellen klaar



U Kiest: **Stimulatie-Opties Patiënt**

I Optie A: **OneTouch NMT (AUTO-modus)**

- 1 Start de case**

Zet de caseregistratie **aan/uit**

Selecteer **CASE STARTEN** om de **automatische modus** te starten



Of
- 2 Volledige Monitoring Geïnitieerd**

Referentiestroom en **blokdiepte** worden automatisch bepaald en gemonitord



- 3 Selecteer de gewenste weergave**

Veeg om door de beschikbare golfvormen/weergaven te navigeren



I Optie B: **Manuele Stimulatie**

- 1 Druk op de Mode-knop om de modus te selecteren**

- 2 Selecteer Stimulatiemodus**

Selecteer de **TOF-modus**

Bevestig de modusselectie



Of
- 3 Stroom aanpassen zoals nodig**

Pas aan met het **scrollwiel**

+ Druk op **Enter**

Of

Pas aan met het **aanraakscherm**

- 4 Druk op Play om Stimulatie te Initiëren**

Druk op de **afspeeltoets**



Druk kort in voor een **enkele stimulatie**

Of

Druk lang in (> 2 sec) voor **herhaalde stimulatie**

I **Reiniging en Desinfectering**

- ▶ **Reiniging**: Zeep en Water, met een vochtige doek aangebracht, zijn geschikt om de STIMPOD te reinigen en te desinfecteren. Het is zeer belangrijk dat geen vocht de STIMPOD binnendringt.
- ▶ **Desinfectering**: In de handel verkrijgbare methanol-vrije ontsmettingsmiddelen in een ethyl-alcohol-basis kunnen voor desinfectie gebruikt worden.



Démarrage Rapide

French (Français)

Monitoring NMT: Préparation de l'AMG



1 Vérifier les piles & Allumer l'Appareil

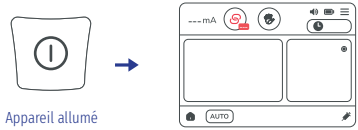
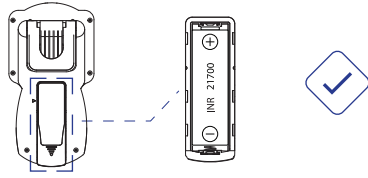

2 Connecter le câble du Monitoring NMT AMG

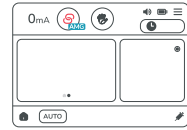
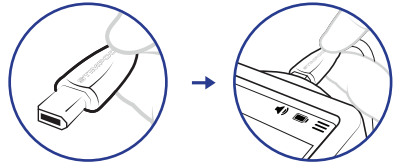

3 Préparer la Peau du Patient pour le Monitoring

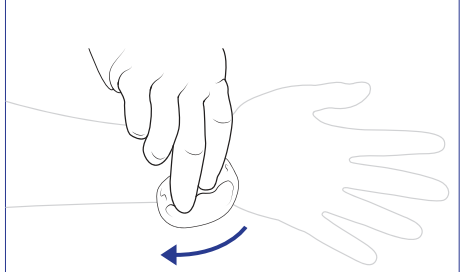

4 Attacher les électrodes

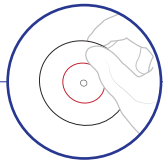

5 Connecter les clips aux électrodes



6 Fixer l'accéléromètre au membre qui se contracte



Préparation du Patient

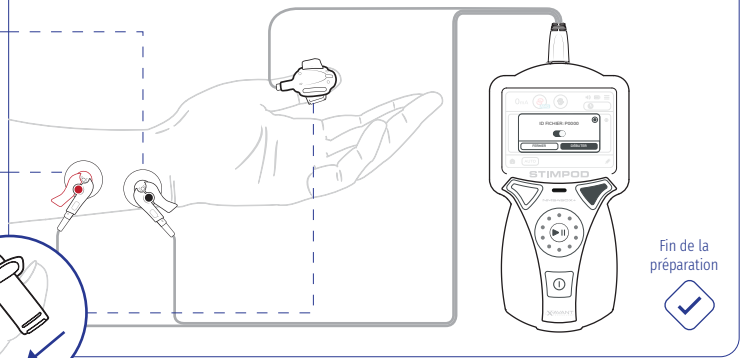



» Démarrage Rapide

French (Français)

I Monitoring NMT: Préparation de l'EMG



1 Vérifier les piles & Allumer l'Appareil

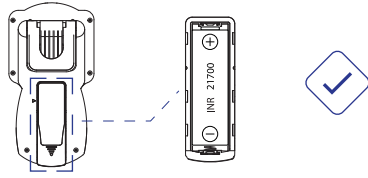

2 Connecter le câble du Monitoring NMT à l'EMG

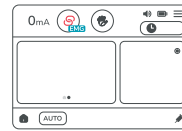
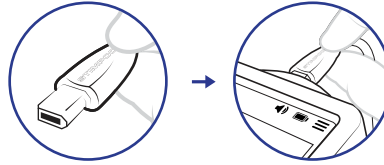

3 Préparer la Peau du Patient pour le Monitoring

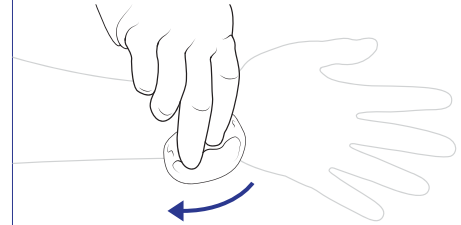

4 Attacher les électrodes de l'EMG au patient

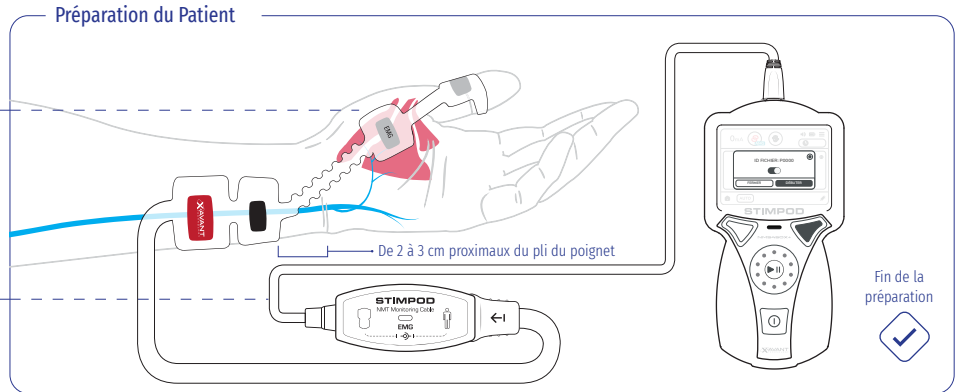

5 Connecter les électrodes de l'EMG au câble de Monitoring NMT de l'EMG

Fin de la préparation



Vous choisissez: **Options de Stimulation du Patient** Options I

Option A: OneTouch NMT (stimulation AUTOMATIQUE)

- Démarrer le cas de suivi**

Activer/désactiver l'enregistrement du cas de suivi via le commutateur

Sélectionner **DÉMARRER LE CAS DE SUIVI** pour lancer le mode automatique

Ou
- Monitoring complet initié**

Courant de référence et profond de bloc déterminés puis contrôlés automatiquement
- Sélectionner la vue souhaitée**

Balayer du doigt pour afficher les formes d'onde et les vues disponibles

Option B: Stimulation Manuelle

- Appuyer sur le bouton Mode pour sélectionner le mode**
- Sélectionner le mode de stimulation**

Sélectionner le mode TOF

Confirmer la sélection du mode

Ou
- Ajuster le courant comme requis**

Régler avec la molette de défilement

Appuyer sur Entrée

Ou

Régler via l'écran tactile
- Appuyer sur Play pour Initier la Stimulation**

Appuyer sur le bouton de lecture

Appuyer brièvement pour une seule stimulation

Ou

Appuyer longuement (plus de 2 secondes) pour une stimulation répétée

Nettoyage et Désinfection

- ▶ **Nettoyage:** Vous pouvez nettoyer et désinfecter le STIMPOD avec un chiffon humide imprégné de savon. Il est impératif que l'humidité ne pénètre pas à l'intérieur du STIMPOD.
- ▶ **Désinfection:** Vous pouvez utiliser n'importe quel désinfectant à base d'alcool éthylique disponible dans le commerce, à condition qu'il ne contienne pas de méthanol.



Schnellstart

German (Deutsch)

NMT-Überwachung: AMG-Einrichtung



1 Batterien prüfen & Gerät einschalten

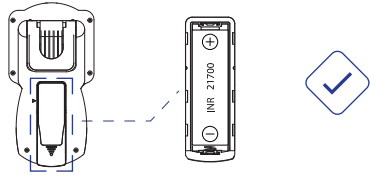

2 NMT-Überwachungskabel am AMG einstecken

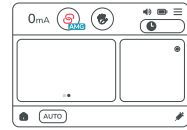
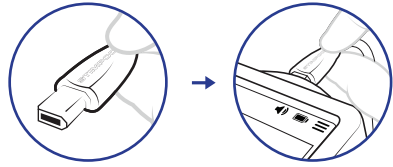

3 Haut des Patienten für Überwachung vorbereiten

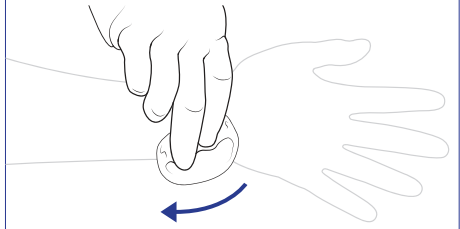

4 Elektroden anbringen

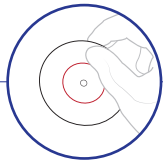

5 Clips an die Elektroden befestigen



6 Befestigen Sie den Beschleunigungsmesser am entsprechenden kontrahierenden Gelenk



Patientenvorbereitung

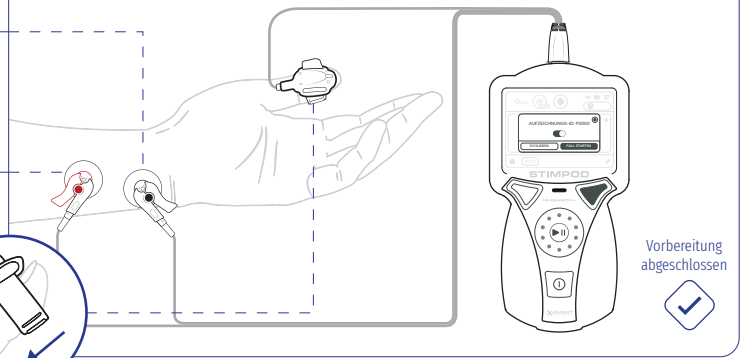



Schnellstart

German (Deutsch)

NMT-Überwachung: EMG-Einrichtung



1 Batterien prüfen & Gerät einschalten

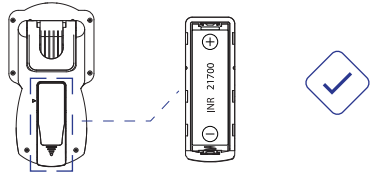

2 NMT-Überwachungskabel am EMG einstecken

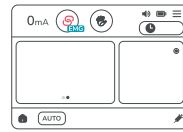
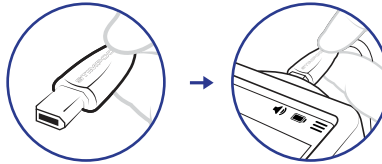

3 Haut des Patienten für Überwachung vorbereiten

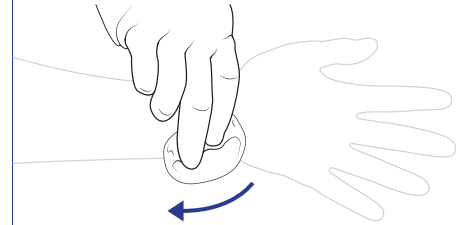

4 EMG-Elektrode am Patienten anbringen

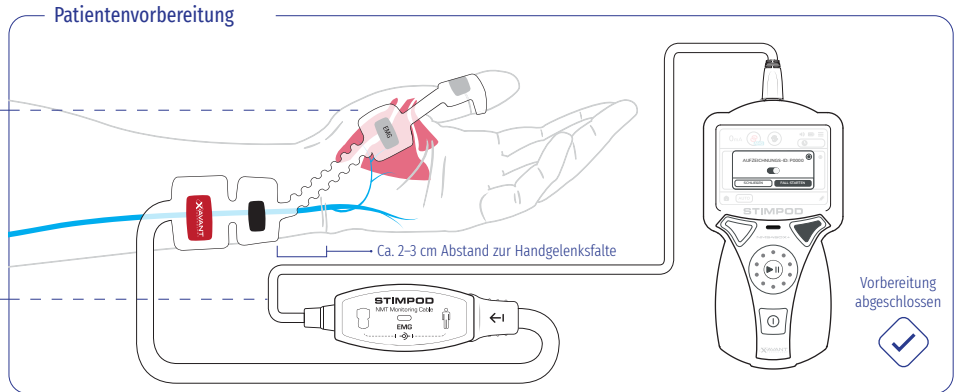

5 EMG-Elektrode mit NMT-Überwachungskabel des EMG verbinden

Sie Wählen: **Optionen für Patientenstimulation**

I Option A: OneTouch-NMT (AUTO-Modus)

- 1 Fall starten**

Fallaufnahme ein/aus schalten

Wählen Sie die **START CASE**, um den **Auto-Modus** zu aktivieren.



Oder
- 2 Vollüberwachung gestartet**

Referenzstromstärke und Blocktiefe werden automatisch ermittelt und überwacht



- 3 Gewünschte Anzeige wählen**

Navigieren Sie durch die verfügbaren Wellenformen/Anzeigen mit dem Finger

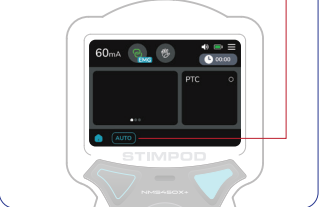

I Option B: Manuelle Stimulation

- 1 Drücken Sie zur Auswahl des Modus die Modustaste**

- 2 Stimulationsmodus wählen**

TOF-Modus auswählen

Modusauswahl bestätigen

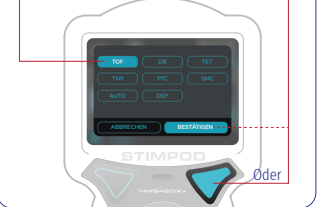

Oder
- 3 Stromstärke nach Bedarf einstellen**

Einstellung mit dem Scrollrad



Oder

Einstellung über Touch-Display

- 4 Auf Start drücken, um Stimulation zu beginnen**

Play-Taste drücken

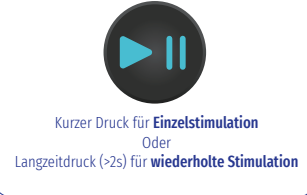

Kurzer Druck für **Einzelstimulation**
Oder
Langzeitdruck (>2s) für **wiederholte Stimulation**

I Reinigung und Desinfektion

- ▶ **Reinigung:** Verwenden Sie zur Reinigung des STIMPOD's ein mit Wasser und Seife angefeuchtetes Tuch. Bitte achten Sie unbedingt darauf, dass keine Feuchtigkeit in den STIMPOD eindringt.
- ▶ **Desinfektion:** Zur Desinfektion kann jedes handelsübliche methanolfreie Desinfektionsmittel auf Ethylalkoholbasis, leicht feucht mit einem Tuch, aufgetragen werden. Hier können beispielsweise folgende Produkte eingesetzt werden: Meliseptol® New Formula, Meliseptol® Pure, Meliseptol® HBV Tissues, Mikrozid AF liquid and Mikrozid AF Wipes.



Σύντομος Οδηγός

Greek (ελληνικά)

I Παρακολούθηση NMT: Προετοιμασία AMG



1 Ελέγξτε τις μπαταρίες και ενεργοποιήστε τη συσκευή

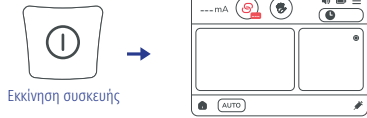
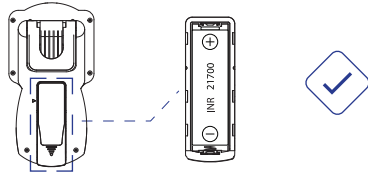

2 Συνδέστε το NMT καλώδιο παρακολούθησης AMG

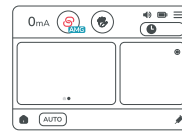
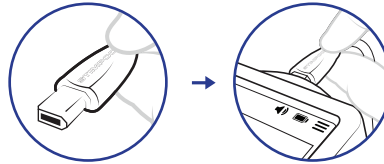

3 Προετοιμάστε το δέρμα του ασθενή για παρακολούθηση

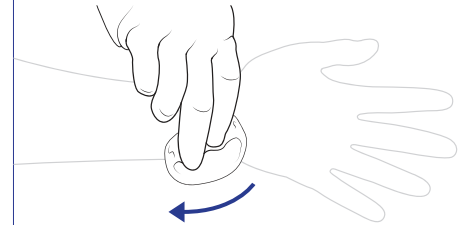

4 Εφαρμόστε τα ηλεκτρόδια

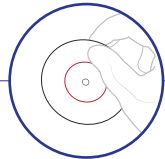

5 Τοποθετήστε τα κλιπς στα ηλεκτρόδια

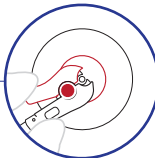

6 Συνδέστε το επιταχυνσιόμετρο στο κατάλληλο μέρος του σώματος που συσπάται

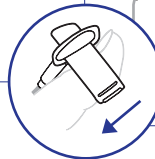

Προετοιμασία ασθενή

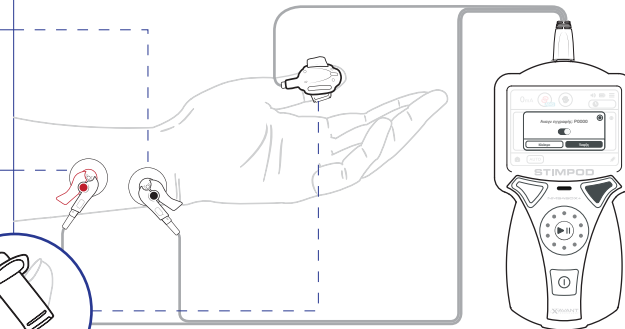

Ολοκλήρωση προετοιμασίας





Σύντομος Οδηγός

Greek (ελληνικά)

1 Παρακολούθηση NMT: Προετοιμασία EMG



- 1 Ελέγξτε τις μπαταρίες και ενεργοποιήστε τη συσκευή

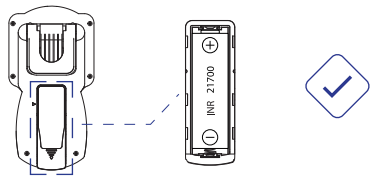

- 2 Συνδέστε το NMT καλώδιο παρακολούθησης EMG

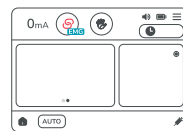
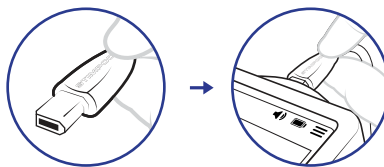

- 3 Προετοιμάστε το δέρμα του ασθενή για παρακολούθηση

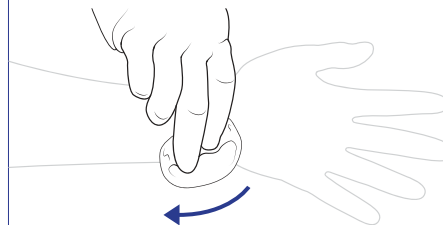

- 4 Εφαρμόστε τα ηλεκτρόδια EMG στον ασθενή

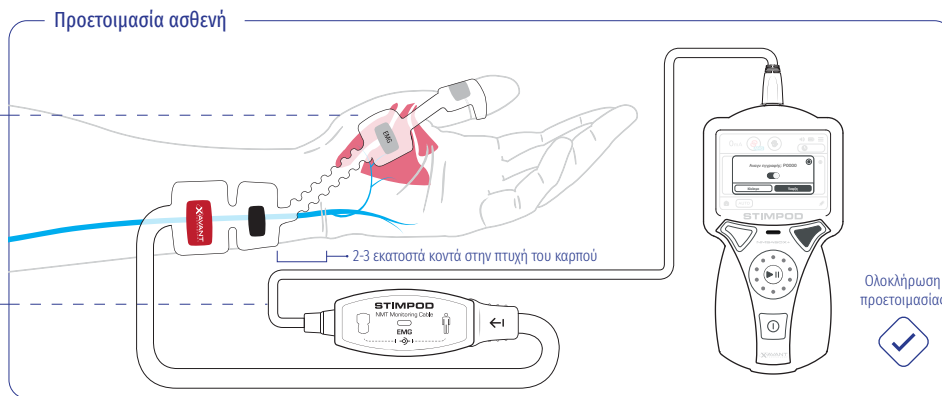

Ολοκλήρωση προετοιμασίας

- 5 Συνδέστε το ηλεκτρόδιο EMG στο NMT καλώδιο παρακολούθησης EMG

Επιλέξτε: **Επιλογές διέγερσης ασθενή**

Για παρακολούθηση του NMT του ασθενή

I Επιλογή A: **NMT Μίας επαφής (αυτόματη λειτουργία)**

1 Νέα περίπτωση

Ενεργοποιήστε/απενεργοποιήστε την εγγραφή για την περίπτωση

Επιλέξτε **START CASE** για να ξεκινήσετε την αυτόματη λειτουργία

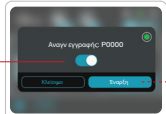

2 Ξεκίνησε η πλήρης παρακολούθηση

Το ρεύμα αναφοράς και το βάθος του αποκλεισμού προδιορίζονται και παρακολουθούνται αυτόματα



3 Επιλέξτε την επιθυμητή προβολή

Σύρετε για πλοήγηση στις διαθέσιμες κυματομορφές/προβολές



I Επιλογή B: **Χειροκίνητη διέγερση**

1 Πατήστε το κουμπί Mode για να επιλέξετε τη λειτουργία

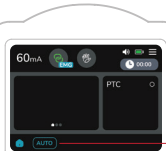

2 Επιλέξτε λειτουργία διέγερσης

Επιλέξτε τη λειτουργία **TOF**

Επιβεβαιώστε την επιλογή του τρόπου λειτουργίας



3 Επιλέξτε το ρεύμα που απαιτείται

Ρυθμίστε χρησιμοποιώντας τον τροχό κύλισης

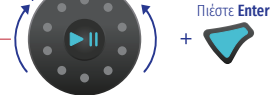

Ρυθμίστε χρησιμοποιώντας την οθόνη αφής

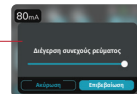

4 Πιέστε Εκκίνηση για να ξεκινήσει η διέγερση

Πατήστε το **πλήκτρο** αναπαγωγής



Πατήστε **σύντομα** για μονή διέγερση

Πατήστε **παρατεταμένα** (> 2 δευτερόλεπτα) για επαναλαμβανόμενη διέγερση

I **Καθάρισμα** και **Απολύμανση**

- ▶ **Καθάρισμα**: Μπορείτε να χρησιμοποιείτε ένα βρεγμένο πανάκι με σαπούνι και νερό για να καθαρίζετε και να κάνετε απολύμανση στο STIMPOD. Είναι αναγκαίο να μην περνάει υγρασία μέσα στο STIMPOD.
- ▶ **Απολύμανση**: Μπορείτε να χρησιμοποιήσετε οποιοδήποτε εμπορικό απολυμαντικό χωρίς μεθανόλη, το οποίο έχει βάση την αιθυλική αλκοόλη.



Avvio Rapido

Italian (Italiano)

Monitoraggio della trasmissione neuromuscolare: impostazione dell'AMG



1 Verificare le batterie e accendere il dispositivo

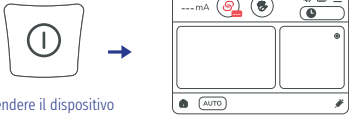
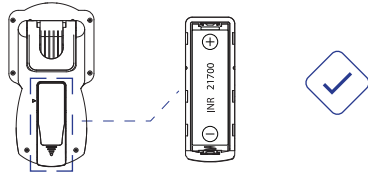

Accendere il dispositivo

2 Collegare il cavo dell'AMG per il monitoraggio della trasmissione neuromuscolare

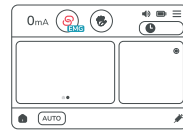
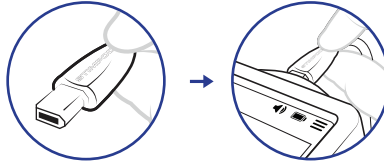

3 Preparare la pelle del paziente per il monitoraggio

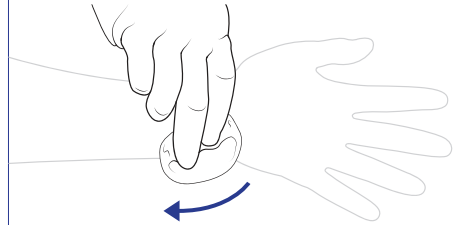

4 Attaccare gli elettrodi

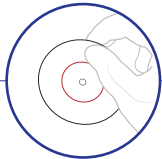

5 Connettere i morsetti agli elettrodi

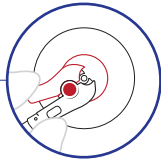

6 Collega l'accelerometro alla corretta parte contratta



Preparazione del paziente

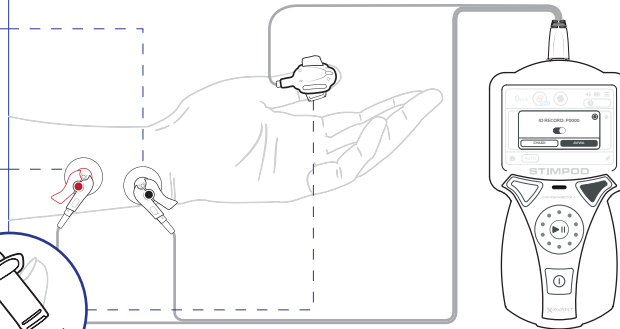

Impostazione conclusa





Avvio Rapido Italian (Italiano)

Monitoraggio della trasmissione neuromuscolare: impostazione dell'EMG



1 Verificare le batterie e accendere il dispositivo

Accendere il dispositivo

2 Collegare il cavo dell'EMG per il monitoraggio della trasmissione neuromuscolare

3 Preparare la pelle del paziente per il monitoraggio

Préparation du Patient

4 Attaccare gli elettrodi dell'elettromiografo al paziente

5 Connettere gli elettrodi dell'EMG al cavo del dispositivo per il monitoraggio della trasmissione neuromuscolare

2-3 cm vicino alla piega del polso

Impostazione conclusa

Come determinare: **le opzioni di stimolazione del paziente**

I Opzione A: TNM OneTouch (modalità AUTO)

- 1** Inizia il caso

Inizia/arresta la registrazione del caso

Seleziona **INIZIO CASO** per avviare la modalità Auto



Oppure
- 2** Monitoraggio completo del caso iniziato

La corrente di riferimento e la profondità del blocco sono determinate e monitorate automaticamente

- 3** Seleziona il tipo di visualizzazione desiderata

Scorri per navigare tra le forme d'onda/visualizzazioni disponibili



I Opzione B: Stimolazione Manuale

- 1** Premi il pulsante **Mode** per selezionare la modalità

- 2** Selezionare la modalità di stimolazione

Seleziona la modalità **TOF**

Conferma la selezione della modalità



Oppure
- 3** Regolare la stimolazione elettrica in base alle necessità

Regola tramite **rotella di scorrimento**

Regola tramite **touch screen**

Oppure

Regola tramite **rotella di scorrimento**

Regola tramite **touch screen**



Premere **Invio**
- 4** Premere Play per iniziare la stimolazione

Premi il tasto **play**



Oppure

Premi brevemente per **stimolazione singola**

Oppure

Premi più a lungo (> 2 sec) per **ripetere la stimolazione**

I Pulizia e Disinfezione

- ▶ **Pulizia:** per pulire e disinfettare STIMPOD, usare un panno inumidito con acqua e sapone. Assicurarsi che tali sostanze non penetrino nell'apparecchio.
- ▶ **Disinfezione:** è possibile impiegare qualsiasi disinfettante con una base ad alcol etilico non contenente metanolo.



クイックスタート

Japanese (日本語)

1 神経筋伝達 (NMT) モニタリング: AMG測定



1 電池を確認して、デバイスをオンにする

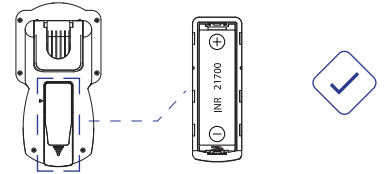

2 AMGモニターケーブルを本体のケーブルコネクタに接続します

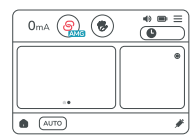
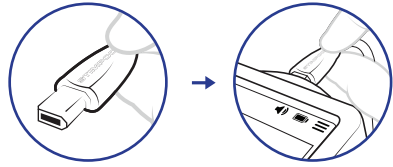

3 電極を貼付する部位を清拭します

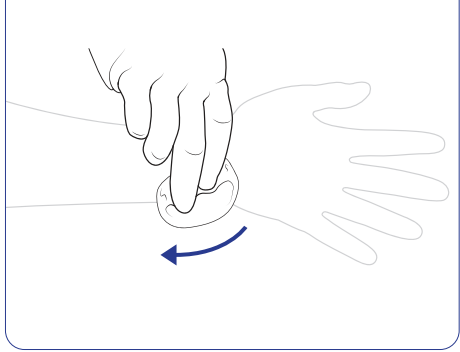

4 電極を取り付けます

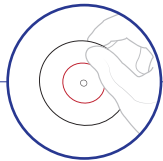

5 モニターケーブルのコネクタクリップを電極に取り付けます



6 加速度計を適切な収縮する付属器に取り付ける

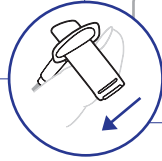

患者設定

設定完了



クイックスタート

Japanese (日本語)

神経筋伝達 (NMT) モニタリング: EMG測定



1 アルカリ乾電池が本体に入っていることを確認し、電源を入れる

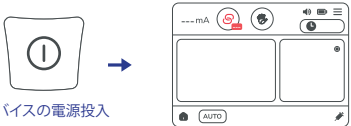
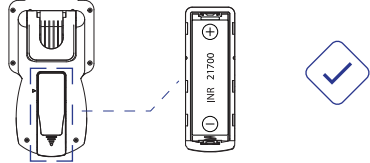

デバイスの電源投入

2 EMGモニターケーブルを本体のケーブルコネクタに接続します

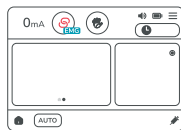
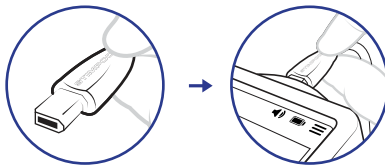

3 電極を貼付する部位を清拭します

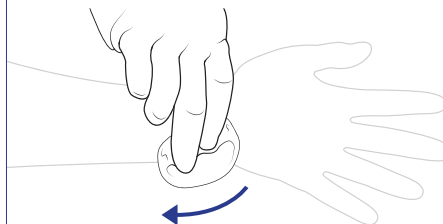

患者の設定

4 患者にEMG電極を取り付けます

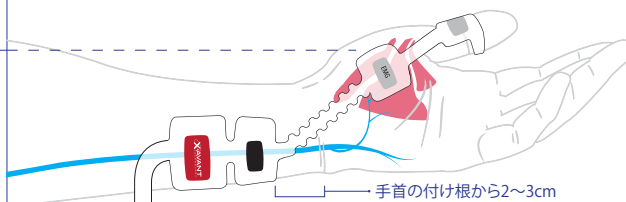

手首の付け根から2~3cm

5 EMG電極をEMGモニターケーブルに接続します

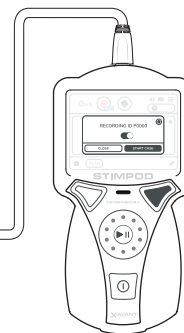
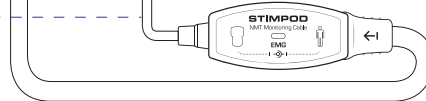

設定完了



オプション: 刺激モードの選択

Ⅰ オプション A: オート (AUTO)

- 1 ケース開始
ケース記録のオン/オフの切替 「ケース開始」を選択して自動モードを開始
または
- 2 オートモード開始
基準電流とブロック深度を自動的に決定し監視する
- 3 希望する表示の選択
スワイプで利用可能な波形/ビューを切替

Ⅰ オプション B: マニュアル設定

- 1 モードボタンを押してモードを選択
- 2 刺激モードを選択
TOFモードを選択
モード選択を確認
または
- 3 電流の調整
スクロールホイールを使用して調整
エンターキーを押す
または
タッチ画面を使用して調整
- 4 刺激を開始
再生キーを押す
短く押すと単一の刺激
または
長押し(2秒以上)で繰り返し刺激

Ⅰ 洗浄と消毒

- ▶ 洗浄: STIMPODの洗浄と消毒には、石鹼水で湿らせた布の使用が適していますSTIMPOD内に絶対に水が浸入しないように注意してください
- ▶ 消毒: メタノールが含まれない、エチルアルコールベースの市販の消毒液であれば、どれでも消毒に使えます



빠른 설치

Korean (한국어)

NMT 모니터링: AMG 설치



1 배터리를 점검하고 기기의 스위치를 켜세요

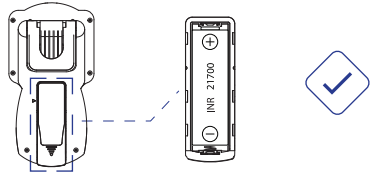

기기의 전원

2 NMT 모니터링 케이블 AMG를 연결하세요

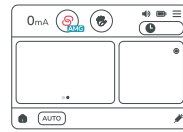
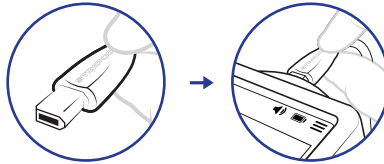

3 모니터할 환자의 피부를 세척하세요

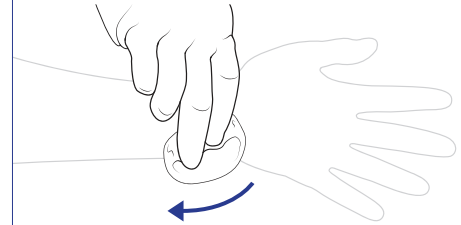

4 전극을 부착하세요

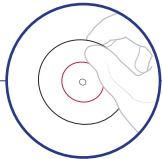

5 클립을 전극에 연결하세요

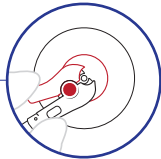

6 가속도계를 적절한 신체 부위에 부착합니다



환자 설치

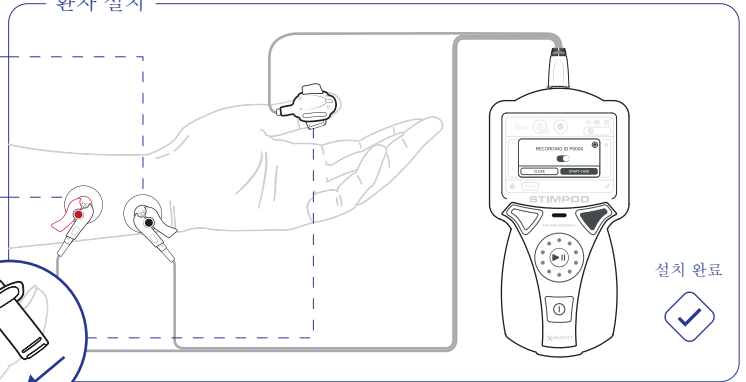

설치 완료



빠른 설치

Korean (한국어)

NMT 모니터링: EMG 설치



1 배터리를 점검하고 기기의 스위치를 켜세요

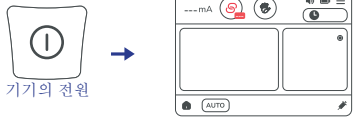
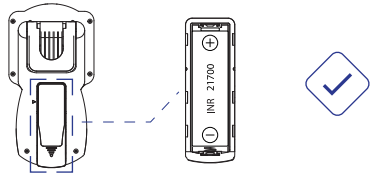

2 NMT 모니터링 케이블 EMG를 연결하세요

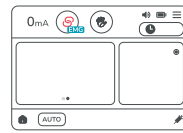
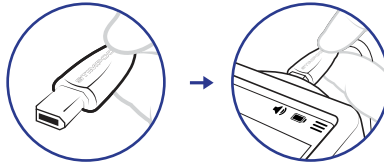

3 모니터할 환자의 피부를 세척하세요

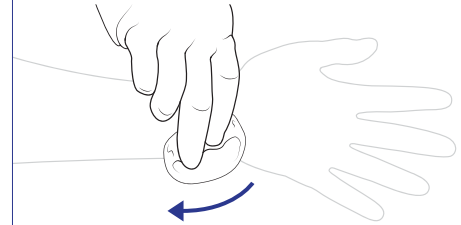

4 EMG 전극을 환자에 부착하세요

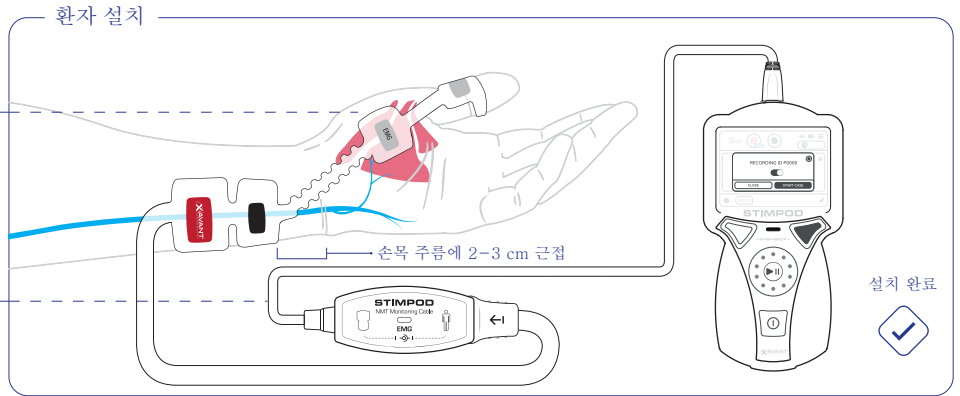

5 EMG 전극을 NMT 모니터링 케이블 EMG에 연결하세요

선택 사항: 환자 자극 옵션

I 옵션 A: 원터치 NMT (자동 모드)

- 1 케이스 시작**
 케이스 기록 켜기/끄기 토글 '케이스 시작'을 선택하여 자율 모드를 시작합니다
 또는



- 2 풀 케이스 모니터링 시작**
 기준 전류 및 차단 깊이가 자동으로 결정되고 모니터링됩니다



- 3 원하는 보기 선택**
 스와이프하여 사용 가능한 파형/보기로 이동합니다

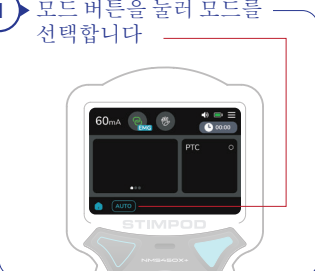

I 옵션 B: 수동 자극

- 1 모드 버튼을 눌러 모드를 선택합니다**

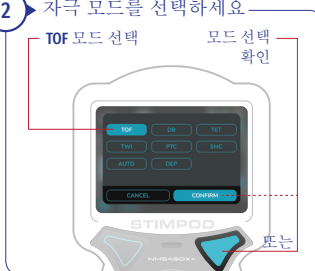
- 2 자극 모드를 선택하세요**
 TOF 모드 선택 모드 선택 확인
 또는

- 3 필요 전류를 조정하세요**
 스크롤 휠을 사용하여 조정
 또는 터치 디스플레이를 사용하여 조정

- 4 플레이를 눌러 자극을 시작하세요**
 재생 키 누르기
 짧게 누르기: 단일 자극
 또는
 길게 누르기(2초): 반복 자극

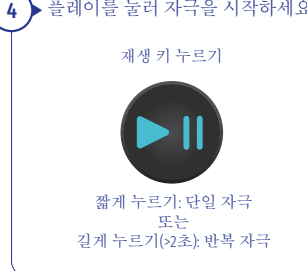

I 세척 및 소독

- ▶ 세척: 젖은 천에 비누와 물을 묻혀 STIMPOD를 세척하고 소독하는 것이 가장 적합합니다. STIMPOD에 물이 들어가지 않도록 하는 것이 필수적입니다.
- ▶ 소독: 시중에서 판매되는 메탄올 함유량 제로의 에틸 알코올 기반의 소독제를 사용할 수 있습니다.



Ātrā Uzstādīšana

Latvian (Latviski)

I NMT Monitorings: AMG uzstādīšana



1 Pārbaudiet baterijas un ieslēdziet ierīci

2 Pievienojiet NMTmonitoringa kabeli AMG

3 Sagatavojiet pacienta ādu monitoringam

4 Pielīmējiet elektrodus

5 Pievienojiet knaibles pie elektrodiem

6 Pievienojiet akcelerometru atbilstošajai kontrahējošajai ķermeņa daļai

Savienojuma shēma

Savienojums veikts



Ātrā Uzstādīšana

Latvian (Latviski)

I NMT Monitorings: EMG uzstādīšana



1 Pārbaudiet baterijas un ieslēdziet ierīci

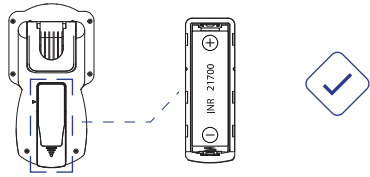

2 Pievienojiet NMTmonitoringa kabeli EMG

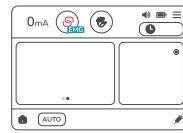
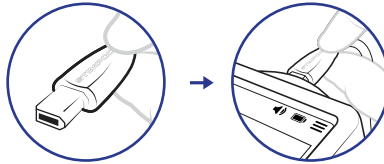

3 Sagatavojiet pacienta ādu monitoringam

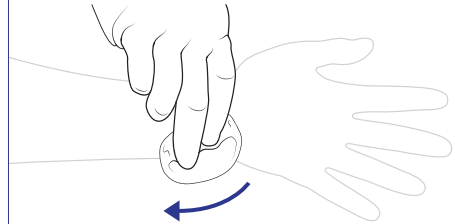

4 Pielīmējiet EMG elektrodu pacientam

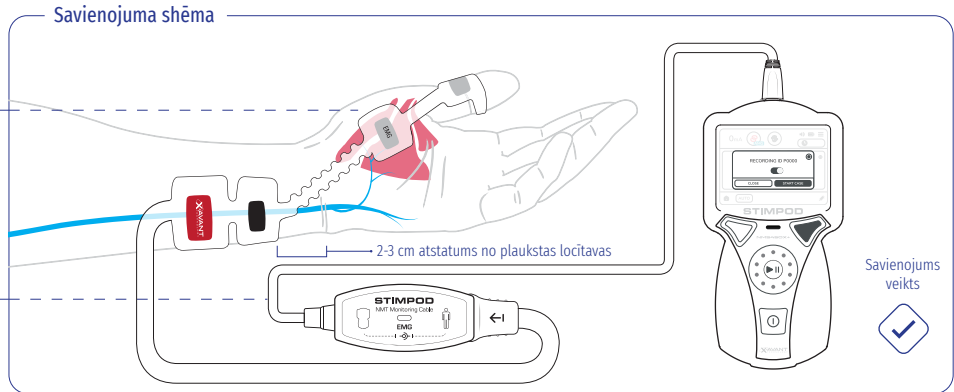

5 Pievienojiet EMG elektrodu piet NMT monitoringa kabeļa EMG

Jūs izvēlieties: **Pacienta stimulācijas varianti**

I Variants A: One Touch NMT (AUTO režīms)

- 1** Uzsāciet procedūru

Pārslēdziet procedūras ierakstu on/off režīmā

Lai uzsāktu automātisko režīmu, nospiediet **START CASE**



Vai
- 2** Uzsāks pilnīgs pacienta monitorings

Atsauces strāvas stiprums un bloķēšanas dziļums tiks noteikts un uzraudzīts automātiski

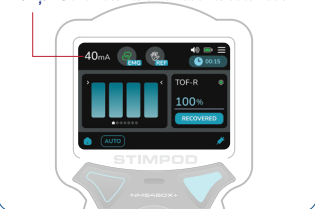
- 3** Izvēlieties vēlamu skatu

Lai pārvietotos pa pieejamajiem līkņu skatiem, pavelciet tos



I Variants B: Manuālā stimulācija

- 1** Lai izvēlētos režīmu, nospiediet pogu **Mode**

- 2** Izvēlieties stimulācijasrežīmu

Atlasiet režīmu **TOF**

Apstipriniet atlasīto režīmu



Vai
- 3** Pielāgojiet strāvu pēc vajadzības

Pielāgojiet, izmantojot ritenīti

Nospiediet **Enter**



Vai

Pielāgojiet, izmantojot **skārienekrānu**
- 4** Lai sāktu stimulāciju piespiediet "Play"

Nospiediet **atskaņošanas** pogu



Lai uzsāktu **vienkāršu stimulāciju**, nospiediet **isi**

Vai

Lai **stimulāciju atkārtotu**, nospiediet ilgāk (> 2 sek.)

I Tīrīšana un Dezinfekcija

- ▶ **Tīrīšana** : STIMPOD tīrīšanai un dezinfekcijai izmantojiet mitru drānu un ziepjūdeni. Ir svarīgi, lai STIMPOD neiekļūtu mitrums.
- ▶ **Dezinfekcija**: Dezinficēšanai var izmantot jebkuru komerciāli pieejamu metanolu nesaturošu dezinfekcijas līdzekli uz etilspirta bāzes.



Hurtigstart

Norwegian (Norsk)

NMT-overvåking: AMG-oppsett



1 Kontroller batteriene og slå enheten på

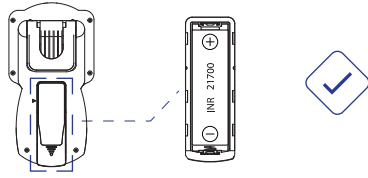

Slå på enheten

2 Koble til NMT overvåkingskabel AMG

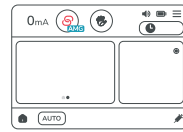
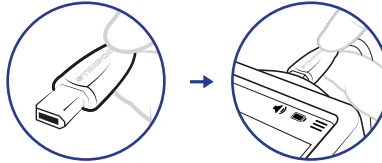

3 Forbered pasientens hud for overvåking

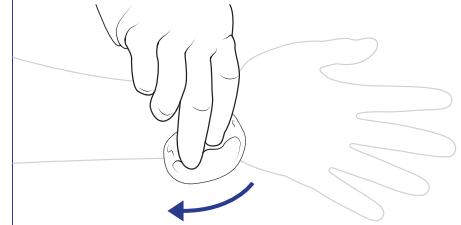

4 Fest elektroder

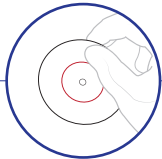

5 Koble klips til elektrodene



6 Fest akselerometeret til en egnet contracting appendage



Pasientoppsett

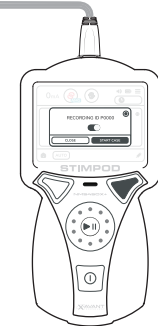
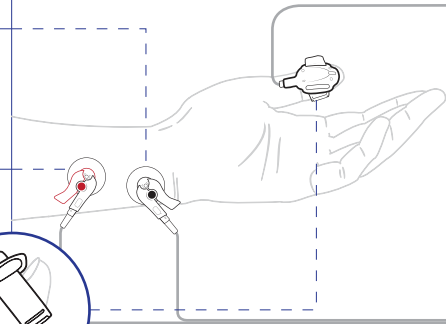

Oppsett klar





Hurtigstart

Norwegian (Norsk)

NMT-overvåking: EMG-oppsett



1 Kontroller batteriene og slå enheten på

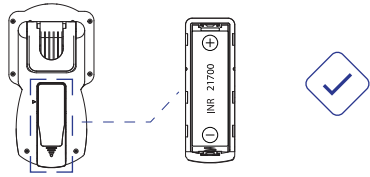

2 Koble til NMT overvåkingskabel EMG

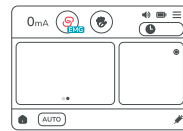
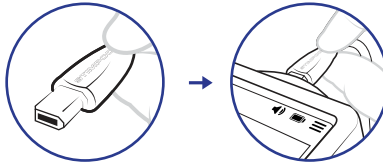

3 Forbered pasientens hud for overvåking

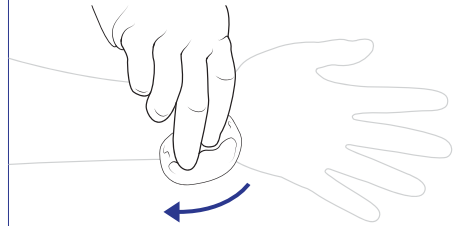

4 Fest EMG-elektrode til pasienten

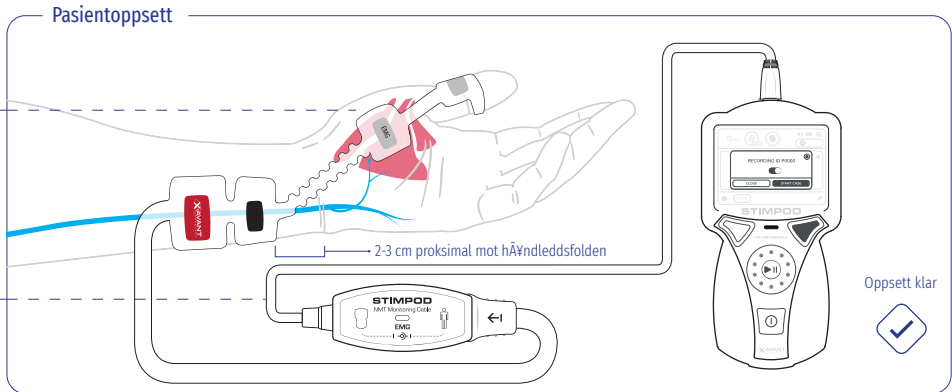

5 Koble EMG-elektrode til NMT-overvåkingskabel EMG

Du velger: **Alternativer for pasientstimulering**

I Alternativ A: **OneTouch NMT (AUTO-modus)**

- 1** Starte case

Veksle mellom case-opptak på/av. Velg **START CASE** for å starte **automodus**



Eller
- 2** Full saksovervåking igangsatt

Referansestrøm og blokkdybde bestemmes og overvåkes automatisk



- 3** Velg ønsket visning

Sveip for å navigere gjennom tilgjengelige bølgeformer/visninger

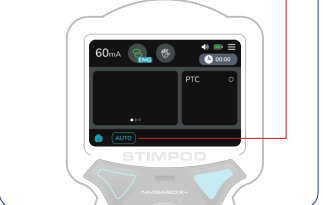

I Alternativ B: **Manuell stimulering**

- 1** Trykk på **modusknappen** for å velge modus

- 2** Velg **stimuleringsmodus**

Velg **TOF-modus** Bekreft modusvalg

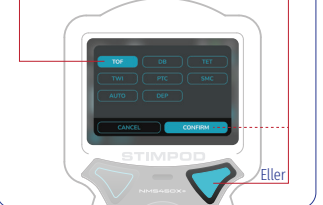

Eller
- 3** Juster strømmen etter behov

Juster med **rullehjulet** + Trykk **Enter**

Eller Juster med **berørings skjermen**

- 4** Trykk på **Play** for å starte stimulering

Trykk på **avspillingknappen**

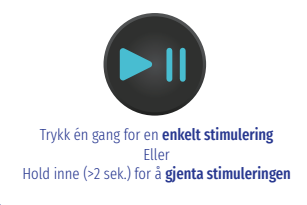

Trykk én gang for en **enkelt stimulering**
Eller Hold inne (>2 sek.) for å **gjenta stimuleringen**

I **Rengjøring og desinfisering**

- ▶ **Rengjøring:** Såpe og vann, påført med en fuktet klut er en egnet måte å rengjøre og desinfisere STIMPOD på. Det er avgjørende at ingen fuktighet trenger inn i STIMPOD.
- ▶ **Desinfisering:** All kommersielt tilgjengelig metanolfritt desinfeksjonsmiddel i en etylalkoholbase kan brukes til deinfisering.



Szybkie Uruchomienie

Polish (Polskie)

I Monitoring NMT: Konfiguracja AMG



1 Sprawdź baterie i włącz urządzenie

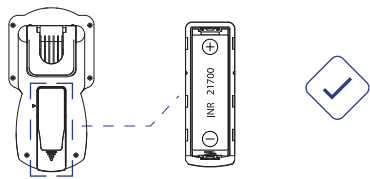

2 Podłącz przewód AMG w celu wykonania monitoringu NMT

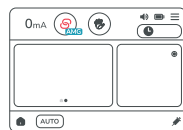
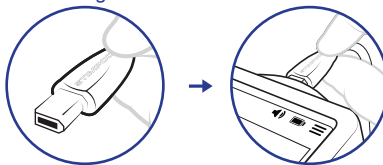

3 Przygotuj skórę pacjenta

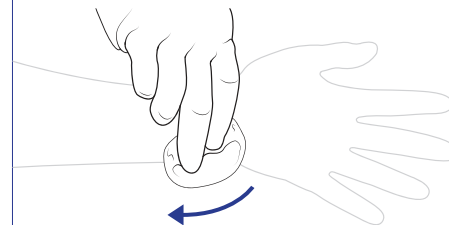

4 Podłącz elektrody

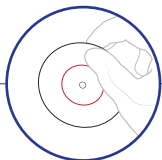

5 Nałóż zaciski na elektrody

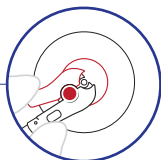

6 Podłącz akcelerometr do odpowiedniej części ciała z kurczącym się mięśniem



Schemat podłączenia

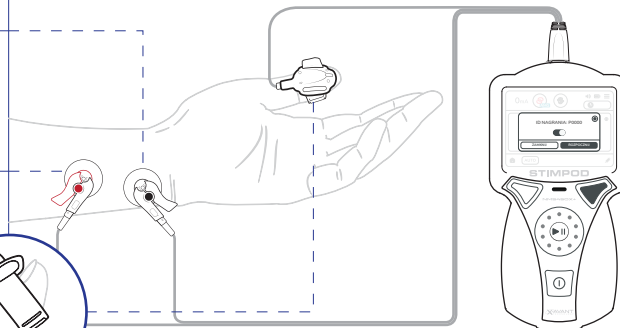

Konfiguracja zakończona





Szybkie Uruchomienie

Polish (Polskie)

Monitoring NMT: Konfiguracja EMG



1 Sprawdź baterie i włącz urządzenie

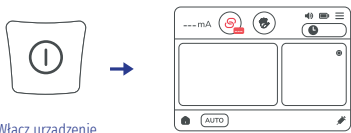
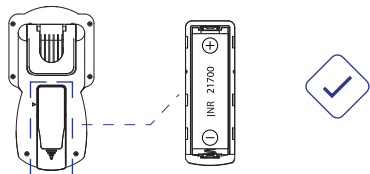

Włącz urządzenie

2 Podłącz przewód EMG w celu wykonania monitoringu NMT

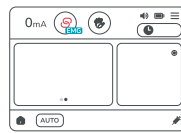
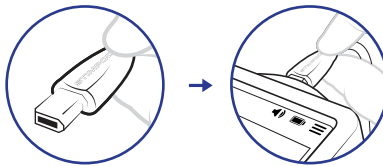

3 Przygotuj skórę pacjenta

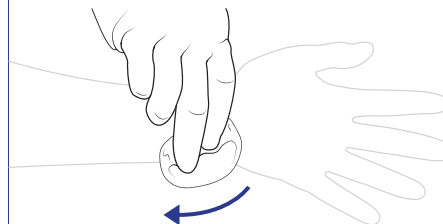

Schemat podłączenia

4 Podłącz elektrodę do ciała pacjenta

5 Podłącz elektrodę EMG do przewodu EMG w celu wykonania monitoringu NMT

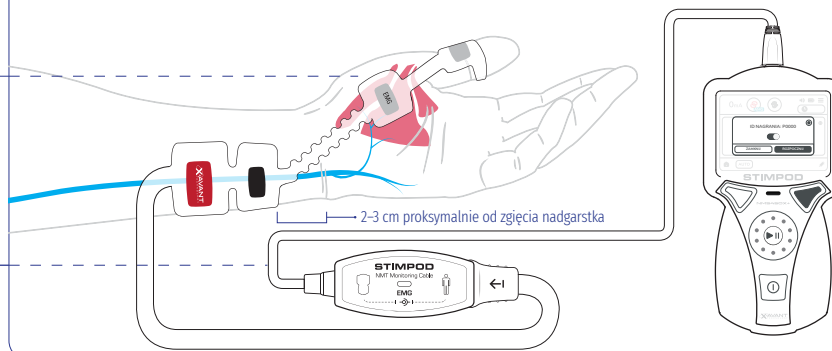

Konfiguracja zakończona



Wybierz: **Opcje Stymulacji Pacjenta****I Opcja A: OneTouch NMT (Tryb AUTO)****1** Rozpocznij badanie

Włączanie/wyłączenie nagrywania badania

Wybierz „START CASE” („rozpocznij badanie”), aby zainicjować tryb automatyczny



lub

2 Rozpoczęto monitoring całościowy

Wartość prądu odniesienia i głębokość blokady są automatycznie określane i monitorowane

**3** Wybierz żądany widok

Przesuń palcem, aby poruszać się po dostępnych wykresach falowych/ widokach

**I Opcja B: Stymulacja Ręczna****1** Naciśnij przycisk „Mode”, aby wybrać tryb**2** Wybierz tryb stymulacji

Wybierz tryb „TOF”

Potwierdź wybór trybu



lub

3 Dostosuj wartość natężenia prądu

Dostosuj za pomocą kółka do przewijania

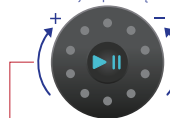

Naciśnij Enter

lub
Dostosuj za pomocą wyświetlacza dotykowego

**4** Naciśnij Play, aby uruchomić stymulację

Naciśnij przycisk odtwarzania



Krótkie naciśnięcie powoduje **pojedynczą stymulację**
lub
Długie naciśnięcie (pow. 2 sek.) powoduje **powtarzaną stymulację**

I Reiniging en Desinfectering

- **Reiniging:** Zeep en Water, met een vochtige doek aangebracht, zijn geschikt om de STIMPOD te reinigen en te desinfecteren. Het is zeer belangrijk dat geen vocht de STIMPOD binnendringt.
- **Desinfectering:** In de handel verkrijgbare methanol-vrije ontsmettingsmiddelen in een ethyl-alcohol-basis kunnen voor desinfectie gebruikt worden.



Início Rápido

Portuguese (O Português)

Monitorização de TNM: ajustes de AMG



1 Verifique as pilhas e ligue o aparelho

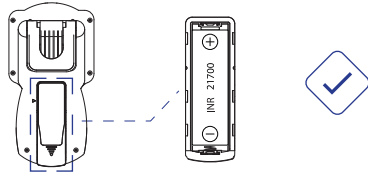

2 Conecte o cabo de monitorização de TNM por AMG

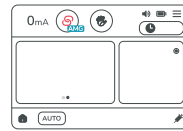
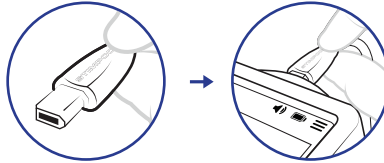

3 Prepare a pele do paciente para monitorização

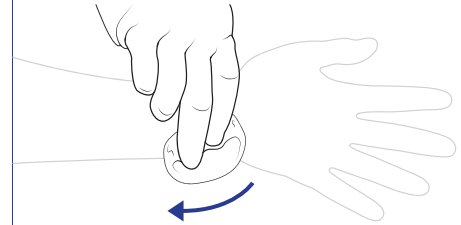

4 Fixe os eletrodos

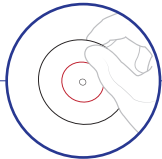

5 Conecte as presilhas aos eletrodos

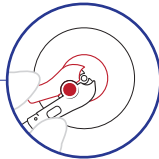

6 Anexar o acelerómetro ao apêndice de contração apropriado



Preparo do Paciente

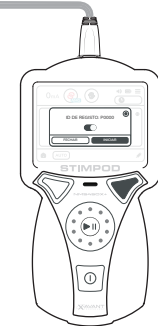
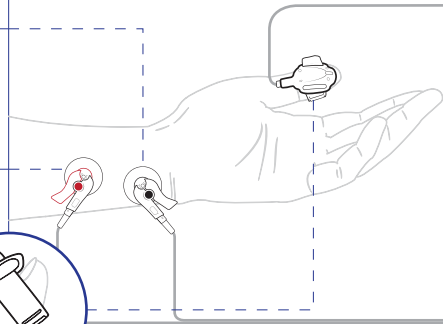

Pronto





Início Rápido

Portuguese (O Português)

Monitorização de TNM: ajustes de EMG



1 Verifique as pilhas e ligue o aparelho

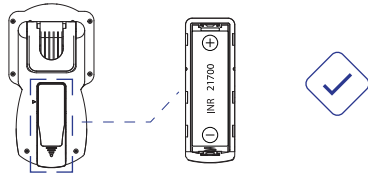

2 Conecte o cabo de monitorização de TNM por EMG

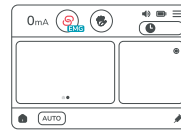
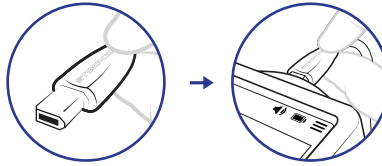

3 Prepare a pele do paciente para monitorização

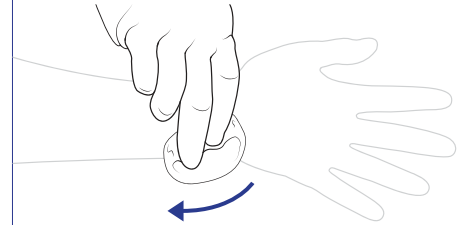

4 Fixe o Eletrodo de EMG ao Paciente

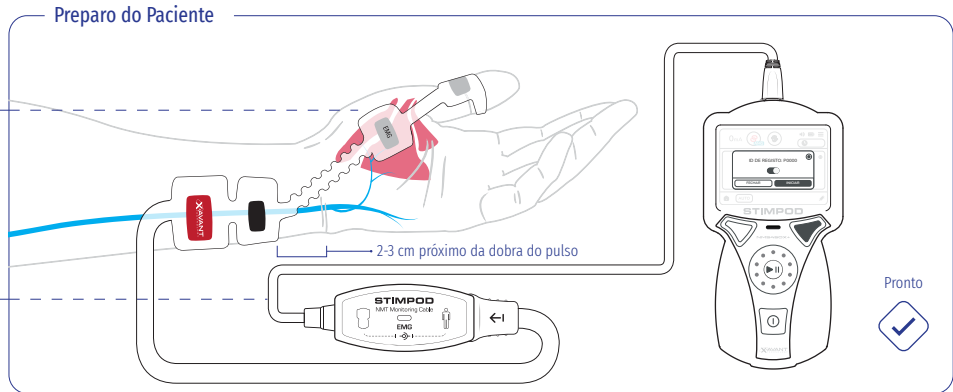

5 Conecte o eletrodo de EMG ao cabo de Monitorização de TNM por EMG

Você Escolhe: **Opções de Estimulação do Paciente**

I Opção A: **OneTouch TNM (Modo AUTO)**

- 1 Iniciar Caso**

Ativar/Desativar a gravação do caso Selecionar **INICIAR CASO** para ativar o modo **Auto**



Ou
- 2 Monitorização de Caso Completo Iniciada**

Corrente de referência e profundidade do bloco determinadas e monitorizadas automaticamente

- 3 Selecionar Vista Desejada**

Deslize para navegar pelas formas de onda e vistas disponíveis



I Opção B: **Estimulação Manual**

- 1 Prima o botão Modo para selecionar o modo**

- 2 Seleccione o Modo de Estimulação**

Selecione o modo **TOF** Confirme a seleção do modo



Ou
- 3 Ajuste a Corrente Conforme Necessário**

Ajuste usando a **roda de deslizamento**

Pressione **Enter**



Ou

Ajustar utilizando o **ecrã tátil**
- 4 Pressione Iniciar para Começar os Estimulos**

Pressione a tecla **play**



Pressão Curta para **Estimulação Única**

Ou

Pressão Longa (>2seg) para **repetição de estimulação**

I **Limpeza e Desinfecção**

- ▶ **Limpeza:** Água e sabão aplicados num pano húmido são suficientes para limpar e desinfectar o STIMPOD. É essencial que não penetre qualquer humidade no STIMPOD.
- ▶ **Desinfecção:** Para a desinfecção pode usar-se qualquer desinfectante, à base de álcool de etileno, sem metanol, comercialmente disponível.



Start Rapid

Romanian (Română)

Monitorizare NMT: Configurare AMG



1 Verificați bateriile și porniți dispozitivul

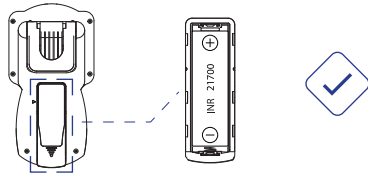

2 Conectați cablul AMG pentru monitorizarea NMT

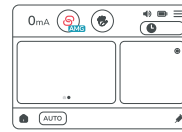
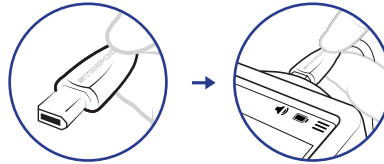

3 Pregătiți pielea pacientului pentru monitorizare

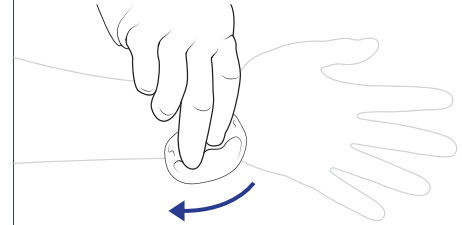

4 Atașați electrozii

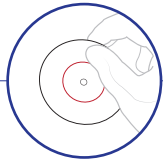

5 Conectați clipsurile la electrozii



6 Atașați accelerometrul la apendicele de contractare corespunzător



Configurarea ansamblului pe pacient

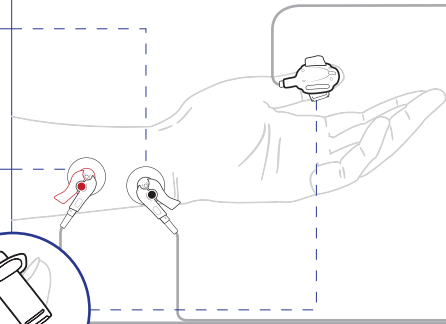

Configurare efectuată



Start Rapid

Romanian (Română)

Monitorizare NMT: Configurare EMG



1 Verificați bateriile și porniți dispozitivul

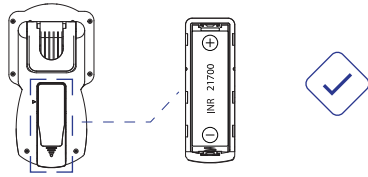

2 Conectați cablul AMG pentru monitorizarea NMT

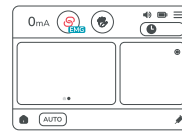
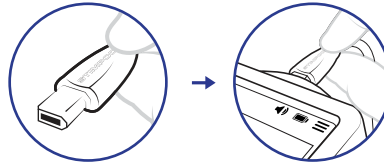

3 Pregătiți pielea pacientului pentru monitorizare

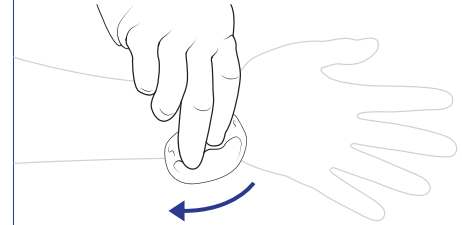

4 Atașați electrodul EMG pe pacient

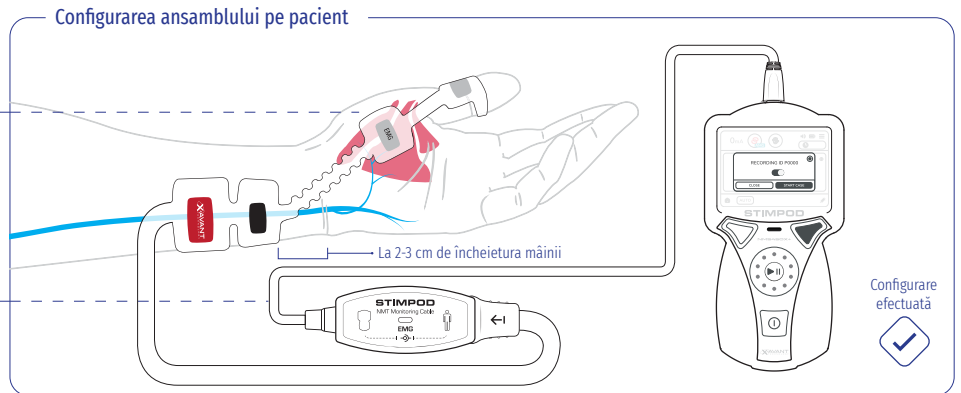

5 Conectați electrodul EMG la cablul EMG de monitorizare NMT

Alegeți: **Opțiuni Stimulare Pacient**

I Opțiunea A: **OneTouch NMT (mod AUTOMAT)**

- 1 Start caz**

Pornire/oprire a înregistrării cazului

Selecți **START CAZ** pentru a porni modul **Auto**



Sau
- 2 Monitorizare completă inițiată**

Curentul de referință și adâncimea blocului determinate și monitorizate automat

- 3 Selectați modul de afișare dorit**

Glisați pentru a naviga prin formele de undă/afișările disponibile



I Opțiunea B: **Stimulare Manuală**

- 1 Apăsați butonul Mod pentru a selecta modul**

- 2 Selectați modul Stimulare**

Selecți modul **TOF**

Confirmați selecția modului



Sau
- 3 Ajustați nivelul curentului, conform cerințelor**

Reglați folosind **roțița de derulare**



Apăsați pe **Enter**

Sau

Reglați folosind **afișajul tactil**

- 4 Apăsați pe Play pentru a iniția Stimularea**

Apăsați tasta de **redare**



Apăsați scurt pentru o **singură stimulare**

Sau

Apăsați lung (> 2 sec) pentru **stimulare repetată**

I **Curățare și Dezinfectare**

- ▶ **Curățare:** Săpun și apă, aplicate cu o lavetă, sunt potrivite pentru curățarea și dezinfectarea STIMPOD-ului. Este imperativ să se evite pătrunderea oricărui lichid în STIMPOD.
- ▶ **Dezinfectare:** Orice dezinfectant disponibil comercial, fără metanol, pe bază de alcool etilic, poate fi folosit pentru dezinfectare.



Inicio Rápido Spanish (Español)

Monitoreo NMT: Configuración AMG



1 Compruebe las pilas y encienda el dispositivo

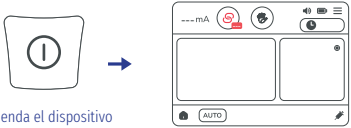
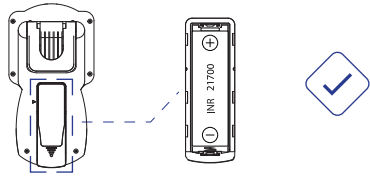

Encienda el dispositivo

2 Conecte el Cable de Monitoreo NMT AMG

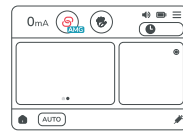
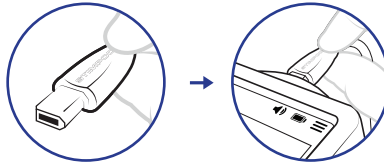

3 Prepare la piel del paciente para el monitoreo

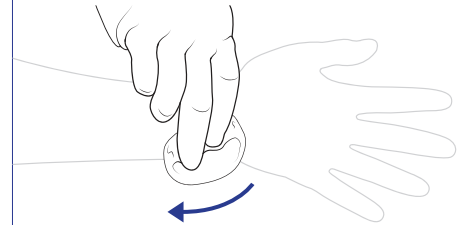

4 Coloque los electrodos

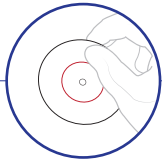

5 Conecte los clips a los electrodos



6 Acople el acelerómetro al apéndice contráctil adecuado



Preparación del Paciente

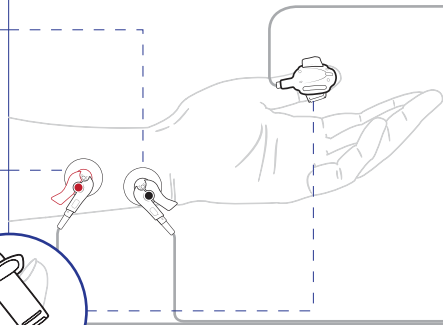

Configuración finalizada





Inicio Rápido Spanish (Español)

Monitoreo NMT: Configuración EMG



1 Compruebe las pilas y encienda el dispositivo

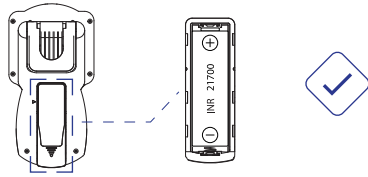

Encienda el dispositivo

2 Conecte el Cable de Monitoreo NMT EMG

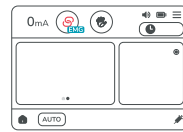
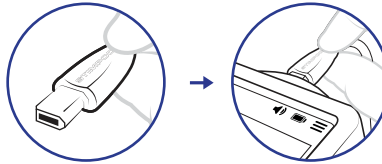

3 Prepare la piel del paciente para el monitoreo

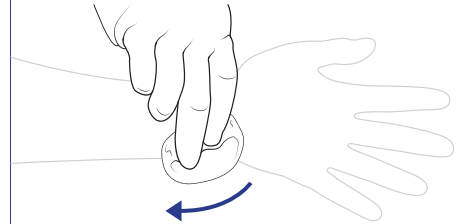

Preparación del Paciente

4 Coloque el electrodo EMG al paciente

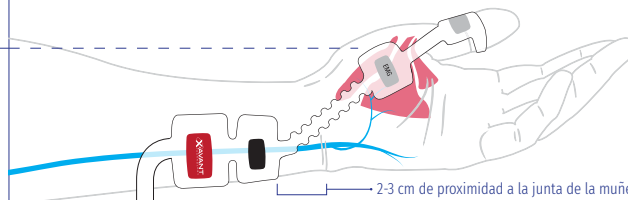

5 Conecte el Electrodo EMG al Cable de Monitoreo NMT EMG

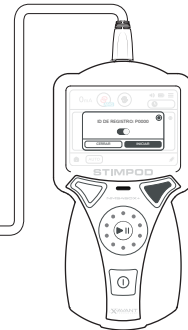
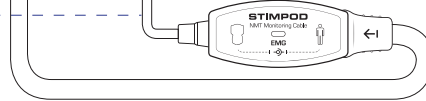

Configuración finalizada



Usted Elige: **Opciones de Estimulación del Paciente**

I Opción A: **OneTouch NMT (modo AUTO)**

- 1** Iniciar caso

Activar/desactivar la grabación de casos

Seleccione **START CASE** para iniciar el modo **Auto**

- 2** Monitoreo Completo de Casos iniciado

La corriente de referencia y profundidad del bloqueo se determinan y monitorizan automáticamente



- 3** Seleccione la visualización deseada

Desliza con el dedo para navegar entre las formas de onda/visualizaciones disponibles



I Opción B: **Estimulación Manual**

- 1** Pulse el botón Modo para seleccionar el modo

- 2** Seleccione el Modo de Estimulación

Seleccionar el modo **TOF**

Confirmar selección de modo

- 3** Ajuste la Corriente Según Sea Necesario

Ajuste con la **rueda**

Ajuste mediante pantalla táctil

- 4** Pulse Play para Iniciar la Estimulación

Pulsar la tecla **play**

Pulsación corta para **estimulación única**

Pulsación larga (>2seg) para **repetir la estimulación**



I **Limpieza y Desinfección**

- ▶ **Limpieza** : Aplicar agua y jabón con un paño húmedo para limpiar y desinfectar el STIMPOD, pero hágalo con cuidado ya que no puede penetrar humedad en el STIMPOD.
- ▶ **Desinfección**: Puede usarse cualquier desinfectante del mercado que no contenga metanol, combinado con una base de alcohol etílico.



Unit 102 Tannery Industrial Park, 309 Derdepoort Road
Silverton, 0184, Pretoria, South Africa
Tel: +27 12 743 5959, Email: support@xavant.com
Web: www.xavant.com